

LOT SPLIT PLAT

SCALE IN FEET 1" = 60'

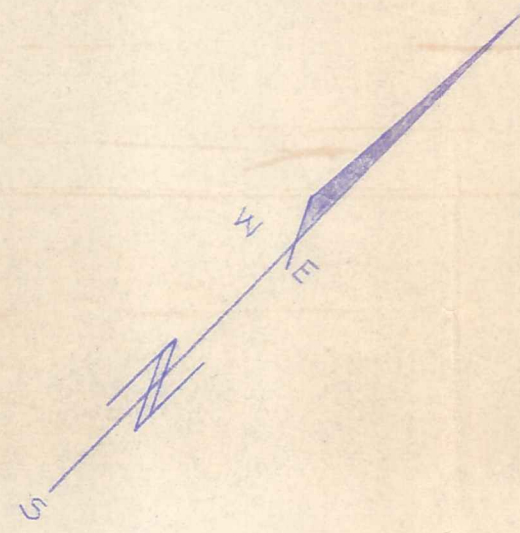

DORIS A. WINTERS
VOL. 1037 Pg. 1350
PARCEL No. 1
PARCEL # 15-048200
14570 ROCK CREEK ROAD

BARBARA M. MARSHALL
VOL. 1070 Pg. 154
PARCEL # 15-101920
14594 ROCK CREEK ROAD
3.2068 ACRES

WILLIAM ALLEN LETTE
VOL. 817 Pg. 297
PARCEL # 15-052100
14646 ROCK CREEK ROAD

WILLIAM A. LETTE
VOL. 1037 Pg. 605
PARCEL # 15-101943
14646 ROCK CREEK ROAD

SURVEY PLAT & LEGAL DESCRIPTION
APPROVED PER R.C. 315.251
R.S. 117106
OFFICE OF THE
GEAUGA COUNTY ENGINEER

I CERTIFY THIS SURVEY IS IN ACCORDANCE WITH THE PROVISIONS
OF CHAPTER 4703-37 OF THE OHIO ADMINISTRATIVE CODE.
Willard F. Schade
WILLARD F. SCHADE JR. PROFESSIONAL SURVEYOR No. 6008 DATE 6-11-06

BEARINGS ARE BASED ON THE CENTERLINE OF ROCK CREEK ROAD BEING
SOUTH 43° 59' 53" WEST AND ARE USED TO DESCRIBE ANGLES ONLY.

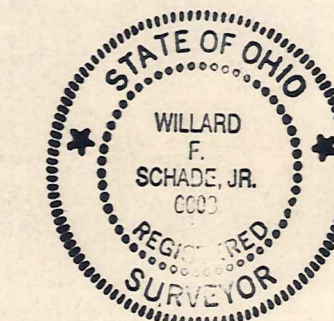

SCHADE SURVEYING COMPANY		
4043 ERIE STREET WILLINGBAY, OHIO 44094	440 951-6454	
LOT SPLIT SURVEY	SCALE 1"=60'	DRAWN BY R.S. WINTERS, C.S.
FOR: DORIS A. WINTERS		REVISED
14570 ROCK CREEK ROAD HAMBDEN TOWNSHIP LOT No. 10 ROAD TRACT GEAUGA COUNTY, OHIO		
DATE 11-6-2006	APPROVED BY	DRAWING NUMBER 06-1059

HAM00183

(HAM 00183)

Winters
Picked up 11-7-06
15-102 544
Vol 1809 PG 3050
File No. 06-1059

1.2210 acres Winters To Marshall

Situated in the Township of Hambden, County of Geauga and State of Ohio: and known as being a part of lot No. 10 in the Bond Tract and is bounded and described as follows:

Beginning on the centerline of Rock Creek Road (State Route 166), 60 feet wide at the intersection of the centerline of Bascome Road, 60 feet wide, a State 4" concrete Right of Way monument with brass plate bears North 43° 59' 53" East along the centerline of said Rock Creek Road a distance of 969.68 feet then South 45° 43' 08" East a distance of 30.00 feet;

Thence South 43° 59' 53" West along the centerline of said Rock Creek Road a distance of 103.52 feet to the southeast corner of land conveyed to Barbara M. Marshall as recorded in Volume 1070, Page 154 of Geauga County Record of Deeds;

Thence continuing South 43° 59' 53" West along the centerline of said Rock Creek Road a distance of 300.00 feet to the southwest corner of said Marshall land and the principal place of beginning of this description;

Thence continuing South 43° 59' 53" West along the centerline of said Rock Creek Road a distance of 41.00 feet to a point;

Thence North 01° 28' 52" East and passing through a 5/8" iron pin set at 44.39 feet, a total distance of 837.00 feet to a 5/8" iron pin set;

Thence North 43° 59' 53" East a distance of 341.00 feet to a 5/8" iron pin set on the west line of land conveyed to William A. Lette as recorded in Volume 1037, Page 605 of Geauga County Record of Deeds;

Thence South 01° 28' 52" West along said west line a distance of 148.00 feet to an Schade one inch iron pipe found at the northeast corner of said Marshall land;

Thence South 43° 59' 53" West along the north line of said Marshall land a distance of 300.00 feet to a Schade one inch iron pipe found at the northwest corner of said Marshall land;

Thence South 01° 28' 52" West along the west line of said Marshall land and passing through a Schade One inch iron pipe found at 644.61 feet, a total distance of 689.00 feet to the centerline of Rock Creek Road and the principal place of beginning of this description and contains 1.2212 acres of land of which 0.0282 acres are in the right of way according to a survey in November, 2006 by Schade Surveying Company, Willard F. Schade Jr. Professional Surveyor. The bearings and distances shall be the same, more or less but subject to all legal highways. Bearings are based on the centerline of Rock Creek Road being South 43° 59' 53" West and are used to describe angles only. Previous Deed Volume 1037, Page 1350, Parcel 1. The intent of this description is convey land from Doris Winters to Barbara M. Marshall the adjoining property to the east.

SURVEY PLAT & LEGAL DESCRIPTION
APPROVED PER R.C. 315.251

R.S. 11/7/06

OFFICE OF THE
GEAUGA COUNTY ENGINEER

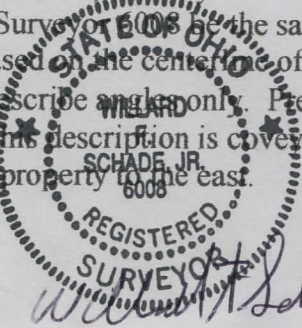

Willard F. Schade Jr. 11-06-06